

ELITE, GRAND TOURING AND EXPRESS TRAVEL TRAILERS

# Passport

## ULTRA LITE

*by Keystone*



GO ANYWHERE



# Passport

## ULTRA LITE

by Keystone

With customer demand for lightweight fuel efficient travel trailers at an all time high, the Passport from Keystone is sure to be the pick of families who want to maximize fuel efficiency, but still maintain all the conveniences of a well appointed, feature packed RV. Sure, towability led you to the Passport, but when you need a travel trailer for those fun weekends or the extended cross country excursion you realize Passport has a full array of features and conveniences built into every model! You know you have arrived at the pinnacle of lite weights when you roll in with a Passport.



PAGES 3-7

## EXPRESS SUPER LITE



The Express Super Lite looks small, but packs a big punch when it comes to living space. Go Anywhere and explore.



PAGES 8-12

## GRAND TOURING



With size and features of a full size camper, the Passport Grand Touring is still made for today's SUV's and half ton vehicles.



PAGES 13-17

## ELITE



Taking camping to the next level, Passport Elite has created the ultimate in lightweight luxury!





199ML SHOWN IN RATTAN DECOR

**Passport**  
ULTRA LITE  
*by Keystone*

★ ★ ★ ★ ★  
**EXPRESS  
SUPER LITE**



What looks small but packs a big punch when it comes to living space? The Passport Express Super Lite! Whether it's the feel of sleeping in the open air with our expandable models or the need for a trailer that can be towed by most small SUV's, the Passport Express Super Lite is the Passport way of making camping easy.

EXPRESS SUPER LITE



195RB SHOWN IN BAYSIDE DECOR



238ML SHOWN IN RATTAN DECOR

# MURPHY BED

STANDARD IN THE 195RB AND 238ML



**STEP 1**



**STEP 2**



**STEP 3**



**STEP 4**

SIMILAR TO A SWISS ARMY KNIFE, THE PASSPORT MURPHY BED IS AN INNOVATIVE WAY TO HAVE BOTH A BED AND SOFA IN A SPACE SAVING DESIGN. NOW AVAILABLE IN THE PASSPORT EXPRESS 195RB AND 238ML.

EXPRESS SUPER LITE



**LIGHTED PASS-THRU STORAGE**



**FOOT FLUSH TOILET**



**EASY OPEN LP TANK COVER**



**HEAVY DUTY DRAWER GUIDES**



# EXPRESS STANDARDS & OPTIONS

## CHASSIS

Engineered specifically for each floor plan  
Fully welded outriggers  
Cambered for added structural support  
Extra support cross members  
Electric slide out system

## CONSTRUCTION

Welded aluminum framed sidewalls  
Laminated gel-coated filon exterior walls  
High density block foam insulation in sidewalls (R-7 insulation)  
Seamless laminated aluminum framed floor 2" thick  
One piece breathable Darco protective wrap  
R-11 high density block floor insulation  
Stamped galvanized 5" thick crowned rafters  
One piece seamless Alpha Superflex TPO roof  
R-11 ceiling rolled fiberglass insulation

## EXTERIOR FEATURES

Insulated lockable radius baggage doors with hold backs  
Insulated radius entrance door with screen door  
Double entry steps at main door  
Heavy duty front mechanical jack

4 scissor style stabilizer jacks  
2-20lb. Propane bottles with flip top cover  
Dual battery rack over A-frame  
Rain gutters with extended downspouts  
Lighted exterior pass thru storage compartment  
Patio entrance light  
Exterior shower w/ hot & cold  
Front diamond plate  
EZ lube axles  
Exterior speakers  
Exterior light at dump valves  
Electric awning

## INTERIOR FEATURES

Residential style furniture with high grade fabric  
13,500 BTU A/C  
Forced air furnace  
6 gallon gas/electric DSI water heater (17.8 gal/hr)  
Water system winterization ready  
Residential durable Beauflor® linoleum  
12 volt DVD/CD/AM/FM stereo, aux input, bluetooth and quality sound speakers  
LED flat screen HD TV

2 tone wood accents  
Residential interior doors

## KITCHEN

Extra large double door dometic refrigerator  
Oversized 60/40 residential sink with sink covers  
Metal high-rise faucet  
Microwave with carousel  
3-burner high output range  
Range hood  
Raised panel hardwood cabinet doors  
Coordinated wall paper border  
Gas Oven

## BATHROOM

Solid wood custom built medicine cabinet with mirror  
Tub surround with built-in shelves  
Radius shower curtain  
Pedestal foot flush toilet  
12 volt power exhaust fan

## BEDROOM (MAIN)

Oversized wardrobes

Nighttime reading lights  
60" x 74" Queen bed  
Under bed storage  
Power outlet at bed side

## SAFETY PACKAGE

4 wheel electric brakes  
Break-away switch  
Heavy duty safety chains with clasp  
Tinted safety glass windows  
Multiple emergency egress windows  
GFI recepticals  
Carbon monoxide detector  
Smoke alarm  
Fire extinguisher  
Propane gas leak detector  
Dead-bolt lock on entrance doors  
Manual override on slide system  
Spare tire kit

## OPTIONS

15,000 BTU A/C  
Aluminum Wheels



DEEP SINIK WITH HIGH-RISE FAUCET AND SINK COVERS



EXTERIOR SHOWER



ADJUSTABLE AWNING



BLACK TANK FLUSH

# ALL NEW EXPANDABLES NOW AVAILABLE!

EXPRESS SUPER LITE



Passport expandables compact design comes with travel-friendly lengths and lightweight floorplans that make this travel trailer towable by many smaller vehicles\*.

\*CHECK WITH YOUR VEHICLE MANUFACTURER FOR TOWING SPECIFICATIONS

The Passport Express Expandable Series has been specifically engineered to maximize sleeping capacity while keeping both weight and overall length of the trailer in mind. Without sacrificing the look, comfort and amenities found in the regular Passport Express, the expandables also offer the latest in hybrid technology.



ROTO-VISE SYSTEM clamps tighter than the competition for a better seal with less effort.



Our tent system makes setting up and tearing down your hybrid a breeze. You no longer have to worry about awkward support bars or the tent canvas not being properly sealed to the tent door.

**AVAILABLE IN 145EXP, 171EXP, 177EXP AND 217EXP FLOOR PLANS**

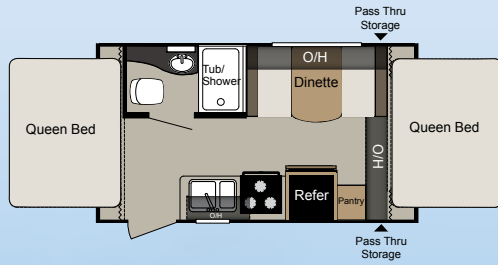

145EXP

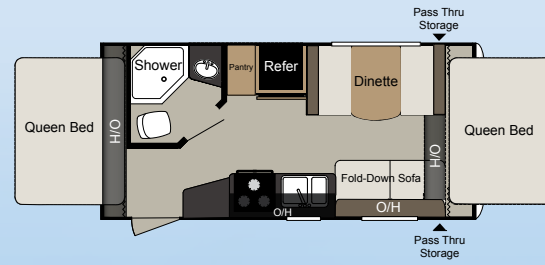

171EXP

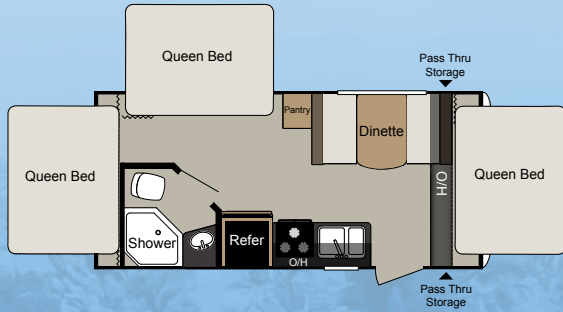

177EXP

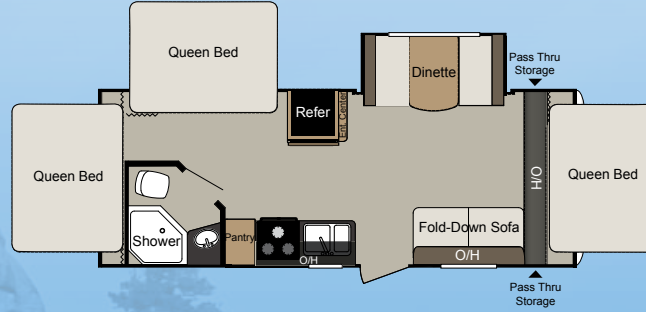

217EXP

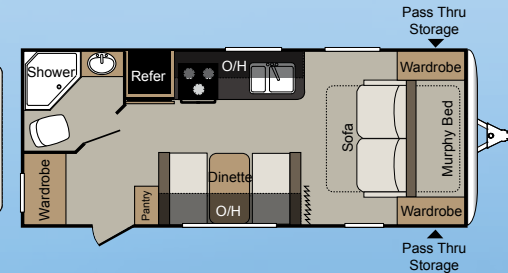

195RB

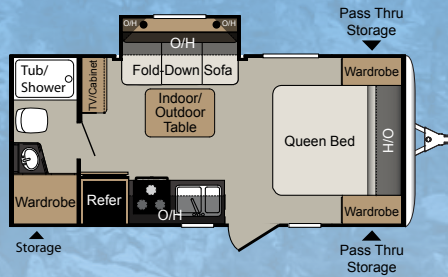

199ML

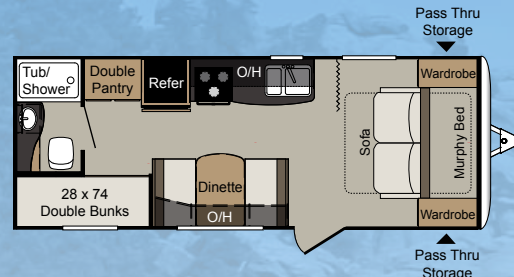

238ML

# EXPRESS FLOOR PLANS

MODEL	SHIPPING WEIGHT	CARRYING CAPACITY	HITCH	LENGTH	HEIGHT	FRESH WATER	WASTE WATER	GRAY WATER	LPG	AWNING
145EXP	TBD	TBD	TBD	TBD	TBD	TBD	TBD	TBD	40	TBD
171EXP	TBD	TBD	TBD	20' 2"	10' 1"	43	38	38	40	TBD
177EXP	TBD	TBD	TBD	TBD	TBD	TBD	TBD	TBD	40	10'
217EXP	TBD	TBD	TBD	TBD	TBD	TBD	TBD	TBD	40	TBD
195RB	3677	1523	350	23' 4"	10' 1"	30	30	30	40	15'
199ML	3571	1629	335	21' 9"	10' 1"	30	30	30	40	10'
238ML	3753	1647	495	24' 11"	10' 2"	30	30	30	40	15'

★ ★ ★ ★ ★

# GRAND TOURING



One word describes the Passport Grand Touring. Amazing! The Passport Grand Touring didn't get the memo that it was suppose to act like the other lite weights. With size and features of a full size camper, this Passport is still made for today's SUV's and half ton vehicles. So go ahead live large and go lite, and get more with a Passport Grand Touring.



3320BH SHOWN IN BAYSIDE DECOR

GRAND TOURING



ENTERTAINMENT CENTER WITH DVD PLAYER, AM/FM RADIO, MP3, AUX PORT AND BLUETOOTH



GAS/ELECTRIC DSI WATER HEATER FOR LONGER HOT SHOWERS



LARGE BUNKHOUSES OFFER PLENTY OF SPACE FOR THE KIDS TO SLEEP AND PLAY GAMES





# Passport

ULTRA LITE  
by Keystone



2890RL SHOWN IN BAYSIDE DECOR



EXTERIOR LIGHTS ALLOW EASY ACCESS  
TO THE TERMINATION VALVE



OUTSIDE KITCHEN  
(AVAILABLE ON 2400BH, 2250RB\*, 2770RB\*, 2920BH, 3220BH, 3320BH)



LOAD EQUALIZATION AXLES (GT AND ELITE)



FOLDING ENTRY ASSIST HANDLE (GT AND ELITE)



ENT. CENTER WITH LED TV AND POCKET DOORS



BUMPER MOUNT GRILL (ON SELECT FLOOR PLANS)

## CHASSIS

Engineered specifically for each floor plan  
 Tube style bumper w/ sewer hose storage  
 Fully welded outriggers  
 Cambered for added structural support  
 Extra support cross members  
 Electric slide out system  
 Enclosed and sealed heated underbelly

## CONSTRUCTION

Welded aluminum framed sidewalls  
 Seamless laminated gel-coated filon exterior walls  
 High density block foam insulation in sidewalls (R-7 insulation)  
 Laminated aluminum framed floor 2" thick  
 One piece breathable Darco protective wrap  
 R-11 high density block floor insulation  
 Stamped galvanized 5" thick crowned rafters  
 One piece seamless Alpha Superflex TPO roof  
 R-11 ceiling rolled fiberglass insulation

## EXTERIOR FEATURES

Insulated lockable radius baggage doors with hold backs  
 Insulated radius entrance door with screen door  
 Triple entry steps at main door  
 Heavy duty front mechanical jack  
 4 scissor style stabilizer jacks  
 2-20lb. Propane bottles with flip top cover  
 Dual battery rack over A-frame  
 Rain gutters with extended downspouts  
 Electric adjustable awning  
 Lighted exterior pass thru storage compartment  
 Portable outside grill (Select models. Not all outdoor kitchen models)  
 Patio entrance light  
 Exterior shower w/ hot & cold  
 Fold away exterior grab handle (main door)  
 Front diamond plate  
 Load Equalization (spread axle design)  
 EZ lube axles  
 Exterior speakers  
 Exterior light at dump valves

## INTERIOR FEATURES

Residential style furniture with high grade fabric  
 Convenience center with slide, lights, awning, water system controls, and 110V receptacle  
 13,500 BTU A/C  
 Forced air furnace  
 Ducted in floor heating  
 6 gallon gas/electric DSI water heater (17.8 gal/hr)  
 Water system winterization ready  
 Residential durable Beauflor® linoleum  
 Digital TV system  
 12 volt DVD/CD/AM/FM stereo, aux input, bluetooth and quality sound speakers  
 LED flat screen HD TV  
 2 tone wood accents  
 Residential light fixtures in slide room  
 King u-shaped dinette  
 Residential interior doors  
 Upgraded residential window treatments and valences  
 Residential style entertainment center with integrated pocket doors

## KITCHEN

Extra large double door dometic refrigerator  
 Oversized 60/40 residential sink with sink covers  
 Metal high-rise faucet  
 Microwave with carousel  
 3-burner high output range  
 Range hood  
 Residential raised panel hardwood cabinet doors  
 Coordinated wall paper border  
 Gas Oven

## BATHROOM

Solid wood custom built medicine cabinet with mirror  
 Tub surround with built-in shelves  
 Radius shower curtain  
 Pedestal foot flush toilet  
 Skylight over tub (most floorplans)  
 12 volt power exhaust fan

## BEDROOM (MAIN)

60"x80" Queen size mattress with quilted bedspread  
 Oversized wardrobes  
 Nighttime reading lights  
 Under bed storage  
 Power outlet at bed side

## SAFETY PACKAGE

4 wheel electric brakes  
 Break-away switch  
 Heavy duty safety chains with clasp  
 Tinted safety glass windows  
 Multiple emergency egress windows  
 GFI recepticals  
 Carbon monoxide detector  
 Smoke alarm  
 Fire extinguisher  
 Propane gas leak detector  
 Dead-bolt lock on entrance doors  
 Manual override on slide system  
 Spare tire kit

## OPTIONS

15,000 BTU A/C  
 Aluminum Wheels



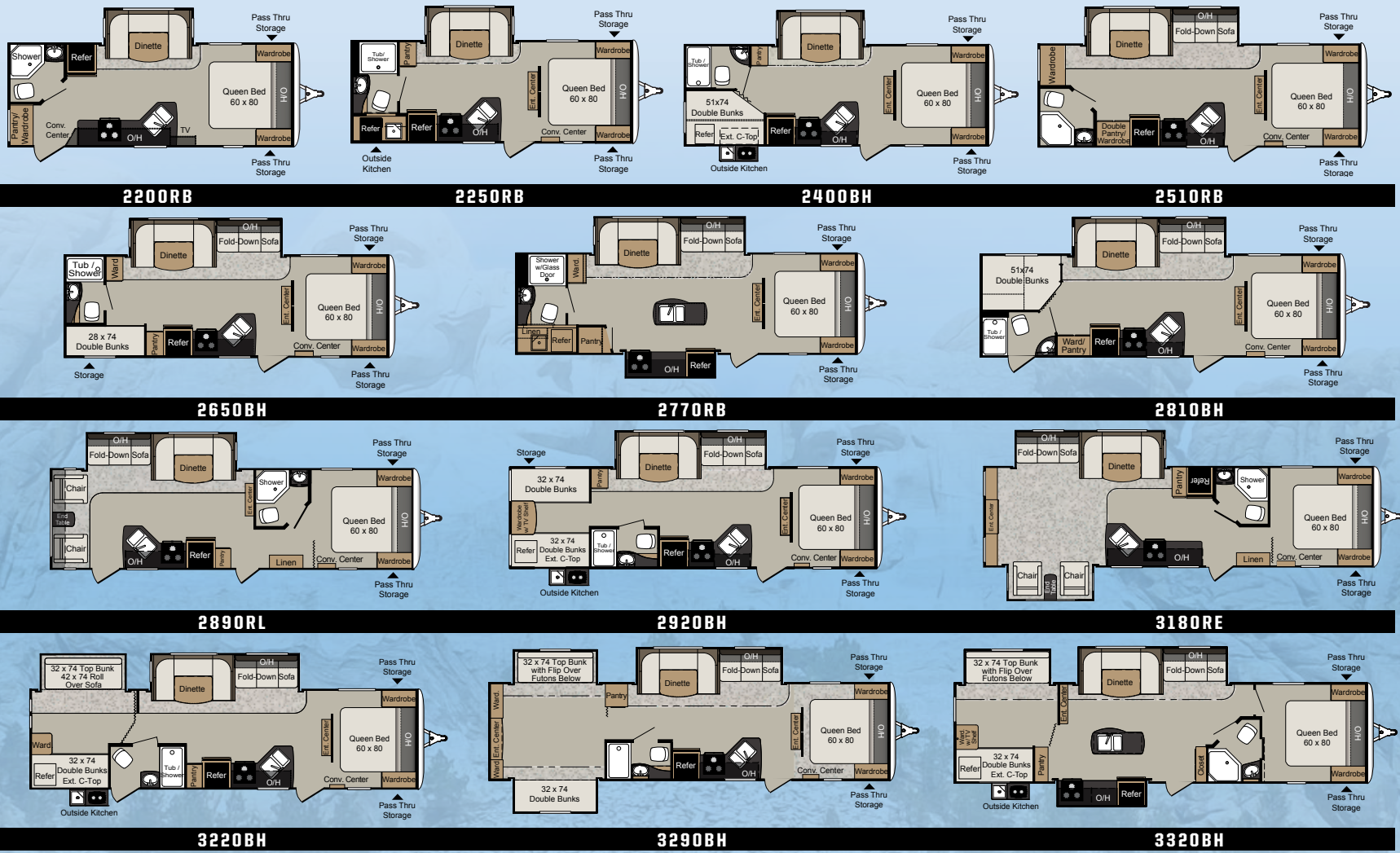

## GRAND TOURING FLOOR PLANS

MODEL	SHIPPING WEIGHT	CARRYING CAPACITY	HITCH	LENGTH	HEIGHT	FRESH WATER	WASTE WATER	GRAY WATER	LPG	AWNING
2200RB	4303	2197	420	25' 10"	10' 7"	30	30	30	40	15'
2250RB	4578	1922	490	26' 4"	10' 7"	30	30	30	40	15'
2400BH	4730	2070	515	27' 10"	10' 7"	30	30	30	40	19'
2510RB	4812	2188	495	28' 10"	10' 7"	30	30	30	40	19'
2650BH	4828	2372	540	29' 4"	10' 7"	30	30	30	40	19'
2770RB	5525	1875	645	30' 9"	10' 9"	30	30	60	40	20'
2810BH	5145	2055	565	31' 10"	10' 9"	30	30	30	40	19'
2890RL	5470	1730	615	32' 9"	10' 9"	30	30	60	40	19'
2920BH	5384	1816	625	32' 10"	10' 9"	30	30	30	40	15'
3180RE	5827	1673	720	34' 11"	10' 9"	30	30	30	40	15'
3220BH	5959	1541	600	35' 5"	10' 9"	30	30	30	40	15' & 10'
3290BH	6308	1692	825	36' 8"	10' 11"	30	30	30	40	15'
3320BH	6562	1438	690	36' 10"	10' 11"	30	30	60	40	19'

★ ★ ★ ★ ★

# ELITE



Taking camping to the next level, Passport has created the ultimate in lightweight luxury! Once inside, you will see why the wide open spaces, all the amenities and high end finishes make this ultra-lite travel trailer Elite indeed.



**31RE** SHOWN IN RATTAN DECOR

**Passport**  
ULTRA LITE  
by Keystone



**ENTERTAINMENT CENTER TO ENJOY WITH THE WHOLE FAMILY**



**DEEP BASIN STAINLESS STEEL SINK WITH PULL OUT SPRAYER**



**60" X 80" TRI-FOLD QUEEN SIZE HIDE-A-BED**

ELITE



# PASSPORT ELITE TOP FEATURES

Sure, towability led you to the Passport, but when you need a travel trailer for those fun weekends or the extended cross country excursion you realize Passport has a full array of features and conveniences built into every model! Passport has features and construction quality that you can depend on.



23RB SHOWN IN BAYSIDE DECOR

ELITE



ADJUSTABLE PANTRY SHELVING  
(SELECT FLOOR PLANS)

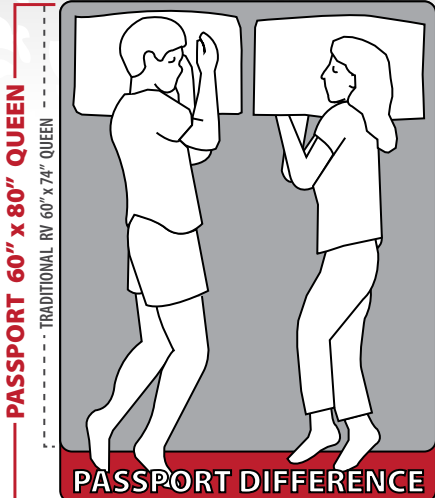

60" X 80" QUEEN SIZE BED  
(ALL GT AND ELITE EXCEPT 23RB & 32FB)



RESIDENTIAL STYLE  
FAUX WOOD BLINDS



FRAMELESS TINTED WINDOWS



HEAVY DUTY DRAWER GUIDES



# Passport

ULTRA LITE  
by Keystone



31RE SHOWN IN RATTAN DECOR



LOAD EQUALIZATION AXLES (GT AND ELITE)



FOLDING ENTRY ASSIST HANDLE (GT AND ELITE)



NEO ANGLE SHOWER (23RB, 30RL, 31RE)



OPTIONAL FREE STANDING DINETTE (N/A 23RB)

ELITE

# ELITE STANDARDS & OPTIONS

## CHASSIS

Engineered specifically for each floor plan  
Tube style bumper w/ sewer hose storage  
Fully welded outriggers  
Cambered for added structural support  
Extra support cross members  
Electric slide out system  
Enclosed and sealed heated underbelly

## CONSTRUCTION

Welded aluminum framed sidewalls  
Seamless laminated gel-coated filon exterior walls  
High density block foam insulation in sidewalls (R-7 insulation)  
Laminated aluminum framed floor 2" thick  
One piece breathable Darco protective wrap  
R-11 high density block floor insulation  
Stamped galvanized 5" thick crowned rafters  
Alpha Superflex TPO one piece seamless rubber roof  
R-11 ceiling rolled fiberglass insulation

## EXTERIOR FEATURES

Insulated lockable radius baggage doors with hold backs  
Insulated radius entrance door with screen door  
Triple entry steps at main door  
Heavy duty front mechanical jack  
4 scissor style stabilizer jacks  
2-20lb. Propane bottles with flip top cover  
Dual battery rack over A-frame  
Rain gutters with extended downspouts  
Electric adjustable awning  
Lighted exterior pass thru storage compartment  
Portable outside grill (most models)  
Patio entrance light  
Exterior shower w/ hot & cold  
Fold away exterior grab handle (main door)  
Front diamond plate  
Load Equalization (spread axle design)  
EZ lube axles  
Exterior speakers  
Exterior light at dump valves  
15" aluminum wheels

Frameless windows  
15" radial tires  
Upgraded graphics package

## INTERIOR FEATURES

Residential style furniture with high grade fabric  
Convenience center with slide, lights, awning, water system controls, and 110V receptacle  
13,500 BTU A/C  
Forced air furnace  
Ducted in floor heating  
6 gallon gas/electric DSI water heater (17.8 gal/hr)  
Water system winterization ready  
Residential durable Beauflor® linoleum  
Digital TV system  
12 volt DVD/CD/AM/FM stereo, aux input, bluetooth and quality sound speakers  
LED flat screen HD TV  
2 tone wood accents  
Residential light fixtures in slide room  
Radius walls  
Residential interior doors  
Upgraded furniture (hide-a-bed)  
High-end window treatments with crown molding (wood valence leather accent)  
Residential style entertainment center with integrated pocket doors  
Wood mini blinds  
Vaulted ceiling

## KITCHEN

Extra large double door domestic refrigerator  
Metal high-rise faucet  
Microwave with carousel  
3-burner high output range  
Range hood  
Residential hardwood cabinet doors  
Coordinated wall paper border  
Gas Oven  
Solid surface countertop  
Stainless steel sink  
Pendant lighting above kitchen countertops

## BATHROOM

Solid wood custom built medicine cabinet with mirror  
Tub surround with built-in shelves  
Radius shower curtain  
Pedestal foot flush toilet  
Skylight over tub (most floorplans)  
12 volt power exhaust fan

## BEDROOM (MAIN)

60"x80" Queen size mattress with quilted bedspread  
Oversized wardrobes  
Nighttime reading lights  
Under bed storage  
Throw pillows  
Power outlet at bedside

## SAFETY PACKAGE

4 wheel electric brakes  
Break-away switch  
Heavy duty safety chains with clasp  
Tinted safety glass windows  
Multiple emergency egress windows  
GFI receptacles  
Carbon monoxide detector  
Smoke alarm  
Fire extinguisher  
Propane gas leak detector  
Dead-bolt lock on entrance doors  
Manual override on slide system  
Spare tire kit

## OPTIONS

15,000 BTU A/C  
Free-standing dinette and chairs (excludes 23RB)





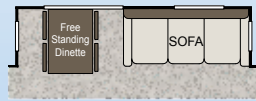

**OPTIONAL  
FREE-STANDING  
DINETTE AND CHAIRS  
(N/A 23RB)**

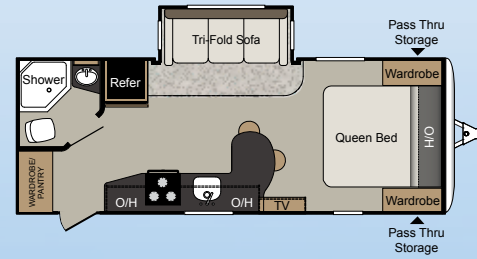

**23RB**



**29BH**

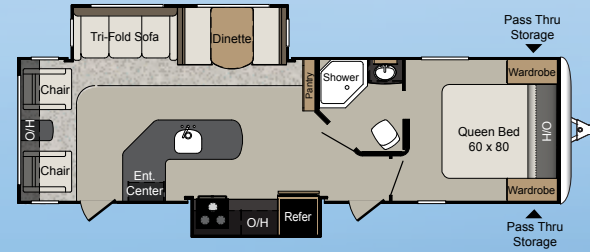

**30RL**

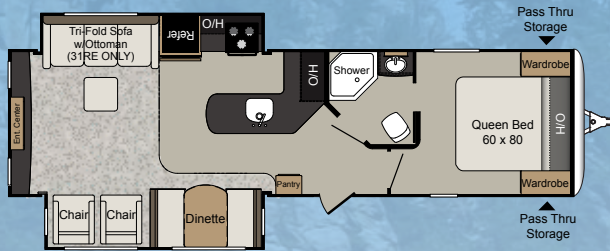

**31RE**

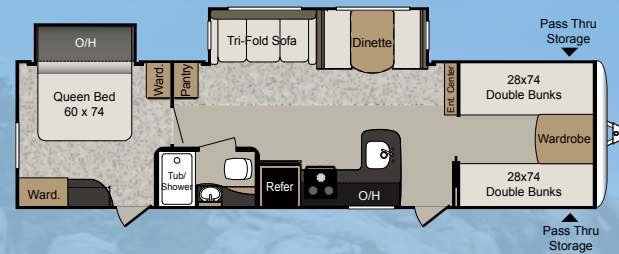

**32FB**

## ELITE FLOOR PLANS

MODEL	SHIPPING WEIGHT	CARRYING CAPACITY	HITCH	LENGTH	HEIGHT	FRESH WATER	WASTE WATER	GRAY WATER	LPG	AWNING
<b>23RB</b>	4608	2192	530	25' 11"	10' 9"	30	30	30	40	15'
<b>29BH</b>	5955	1845	745	33' 8"	10' 8"	30	30	60	40	19'
<b>30RL</b>	6119	1681	665	33' 8"	10' 8"	30	30	60	40	19'
<b>31RE</b>	6216	1784	690	34' 8"	10' 9"	30	30	30	40	12'
<b>32FB</b>	6320	1880	885	35' 4"	10' 9"	30	30	30	40	19'

# Passport

ULTRA LITE  
by Keystone

# PASSPORT CONSTRUCTION



- |  |  |   |
|--|--|---|
| 1. Gel Coated Filon Exterior             | 14. Alpha Superflex TPO One Piece Seamless Rubber Roof | 21. Sloped Slide Roof                           |
| 2. Seamless Pinched Roll Luan Layer      | 15. Roof Decking                                       | 22. Wiper Seals                                 |
| 3. Hi-Density Block Foam Insulation      | 16. R-11 Insulation                                    | 23. Bulb Seal in T-Track                        |
| 4. Interior Wallboard                    | 17. 5" Crowned/Stamped Roof Trusses                    | 24. Aerodynamic Front Wall                      |
| 5. Total Aluminum Frame                  | 18. Hurricane Straps                                   | 25. Easy Lube Axles                             |
| 6. Residential Grade Linoleum            | 19. Diamond Plate                                      | 26. Load Equalization Axles (GT and Elite only) |
| 7. Seamless Floor Decking                | 20. Dual Battery Tray                                  | 27. Radial Tires                                |
| 8. R-11 Hi-Density Block Foam Insulation |  | 28. Radius Entry Steps                          |
| 9. Aluminum Floor Studs                  |  |   |
| 10. Bottom layer floor decking           |  |   |
| 11. Moisture Barrier Wrap                |  |   |
| 12. Enclosed Underbelly (GT & Elite)     |  |   |



# GRANITE DECOR



# BAYSIDE DECOR



# RATTAN DECOR



# STAY IN TOUCH



Passport is always just a touch away. You'll find 360 virtual tours, location of your nearest dealer, photos, videos and all of the latest information about Passport on our easy to navigate website. Everything you need can be accessed anytime, day or night, from home or on the road. You can also find us on the Keystone RV facebook.

[www.keystonerv.com/Passport](http://www.keystonerv.com/Passport)



## KEYSTONE RV RECOMMENDS BUYING LOCALLY

It's up to you where you purchase your new Passport, but may we suggest your local dealer? Not only does it help your local economy and provide jobs, but it will also give you an opportunity to develop a service relationship with someone that will come to know you and your coach. Congratulations on finding the best built, best equipped, best value in the industry, and happy travels!

# Passport

## ULTRA LITE

by Keystone



YOUR LOCAL DEALER:

SEPTEMBER 2014

Product information is as accurate as possible at the date of publication of this brochure. Features, floor plans, and specifications are subject to change without notice. Please also consult Keystone's web site at [keystonerv.com](http://keystonerv.com) for more current product information and specifications. **Tow Vehicle Disclaimer. CAUTION:** Owners of Keystone recreational vehicles are solely responsible for the selection and proper use of tow vehicles. All customers should consult with a motor vehicle manufacturer or their dealer concerning the purchase and use of suitable tow vehicles for Keystone products. Keystone disclaims any liability or damages suffered as a result of the selection, operation, use or misuse of a tow vehicle. **KEYSTONE'S LIMITED WARRANTY DOES NOT COVER DAMAGE TO THE RECREATIONAL VEHICLE OR THE TOW VEHICLE AS A RESULT OF THE SELECTION, OPERATION, USE OR MISUSE OF THE TOW VEHICLE.**



Go RVing  
Life's A Trip™



2642 Hackberry Drive | PO Box 2000  
Goshen, IN 46527-2000  
(574) 535-2100

