

**EASTERN  
EDITION**

# **BULLET**

**CROSSFIRE | Ultra Lite**



# **PREMIER**

— **ULTRA LITE BY BULLET** —



# BUILDING A LEGACY



**Keystone RV  
Company**

When Cole Davis founded Keystone RV in 1996 his vision was clear: Build a quality RV loaded with features priced thousands less than other RVs on the market. To accomplish his goal, Cole built a strong team, focused on keeping overhead low, and empowered employees closest to the customer to make decisions. Within a few short months after opening the doors, Keystone produced its very first camper. Delivering big on quality, features and value, the public fell in love and a star was born.

As customers appetite skyrocketed, new Keystone models were added to satisfy growing customer demand. Along with this tremendous growth came the need for expanded production. To meet this need, more manufacturing plants were built and staffed. By the beginning of 2000, Keystone was leading the industry in fifth wheel and travel trailer sales. Today, Keystone RV Company has grown to encompass over 1 million square feet of manufacturing space with facilities in Goshen, Indiana and Pendleton, Oregon. While Keystone is no longer the small "start up" we once were, our mission has remained true to Cole's vision—"Do the job right and make sure we deliver a quality product every time."

## THE COMPLETE CHOICE

FOR MORE INFORMATION ON KEYSTONE RV VISIT [WWW.BIT.LY/10A0OLK](http://WWW.BIT.LY/10A0OLK)

## BULLET

**FROM THE BEGINNING, THE VISION HAS BEEN SIMPLE: PROVIDE CUSTOMERS AN ULTRA LITE TRAVEL TRAILER WITH UNSURPASSED QUALITY AND VALUE.**

In 2009, this became reality with the Keystone Bullet. After extensive market research, rigorous product development and design the first Bullet Ultra Lite was constructed. In a few short years, Bullet Ultra Lite grew from its humble beginnings to become the #1 ultra lite travel trailer in North America.

Shortly thereafter, Keystone RV launched Premier – the industry's first luxury ultra lite. Staying true to its roots, Premier took the ultra lite segment to the next level. Still unrivaled today, Premier provides more luxury features than any other ultra lite. Bullet's innovation continued in 2015 with the launch of Bullet Crossfire. The inspiration for Bullet Crossfire arose from the need for even smaller and lighter travel trailers. **Today, the vision remains the same.**

## TRUSTED RESULTS

# BULLET #1

**#1 ULTRA LITE TRAVEL TRAILER IN NORTH AMERICA**



**RVDA QUALITY CIRCLE AWARD RECIPIENT 7 YEARS**



# TABLE OF CONTENTS



**BULLET CROSSFIRE  
TRAVEL TRAILERS**



**PAGES 3-4**



**BULLET ULTRA LITE  
TRAVEL TRAILERS**



**PAGES 5-10**



**PREMIER ULTRA LITE  
TRAVEL TRAILERS**



**PAGES 11-16**

# BULLET

## CROSSFIRE

by Keystone



2190EX SHOWN IN SADDLEBROOK DECOR



2190EX BUNK AREA

### BULLET CROSSFIRE TOP FEATURES:

- 13,500 BTU Roof A/C
- Electric Awning
- Two 20 lb. Propane Tanks w/Cover
- Spare Tire
- LED Lighting
- 6 cu. ft. Refrigerator
- Night Shades
- 9" Deep Single Basin Sink
- Full Bath w/Shower Surround



1800RB MURPHY BED SHOWN IN BED POSITION



# BULLET CROSSFIRE FLOOR PLANS

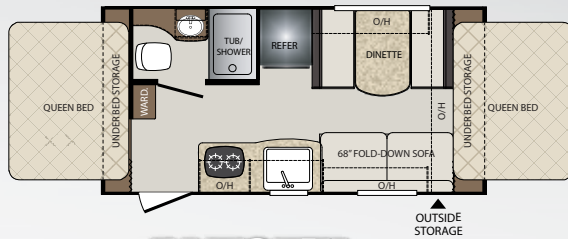

**1650EX NEW**

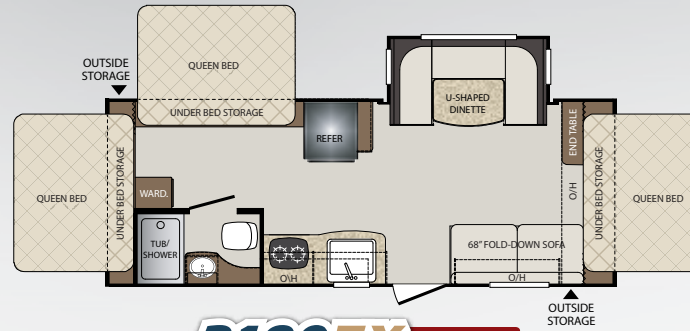

**2190EX NEW**

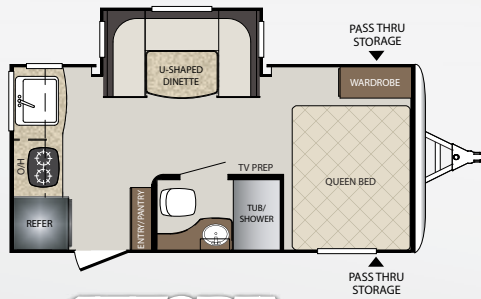

**1750RK NEW**

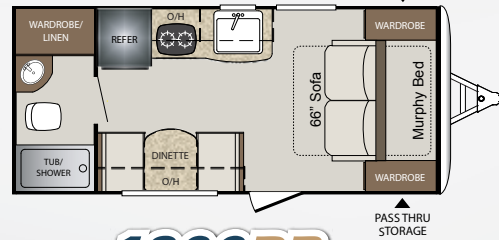

**1800RB**



**1900RD**

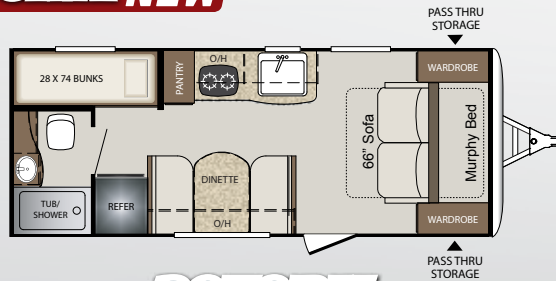

**2070BH**

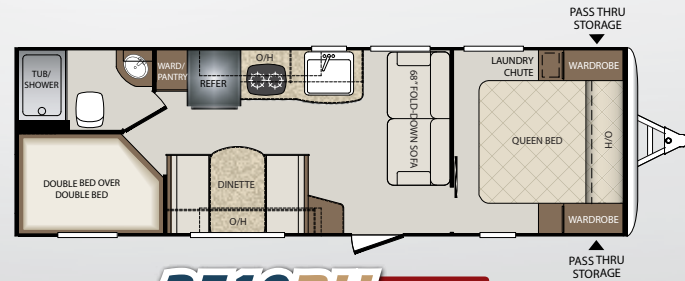

**2510BH NEW**

## CROSSFIRE WEIGHTS AND MEASUREMENTS

MODEL	SHIPPING WEIGHT	CARRYING CAPACITY	HITCH	LENGTH*	HEIGHT	FRESH WATER	WASTE WATER	GRAY WATER	LPG	AWNING
1650EX	3415	1285	435	19' 8"	10' 5"	43	30	30	40	10'
1750RK	3485	1065	400	20' 6"	10' 5"	43	30	60	40	10'
1800RB	3240	1160	440	21' 6"	10' 5"	43	30	30	40	10'
1900RD	3393	1307	485	22' 1"	10' 5"	43	30	30	40	10'
2070BH	3736	1664	420	23' 10"	10' 4"	43	30	30	40	14'
2190EX	4410	1890	560	25' 1"	10' 4"	43	30	30	40	15'
2510BH	4395	2085	480	29' 3"	10' 4"	43	30	30	40	15'

\*Length is defined as the distance from the centerline of the hitch pin/coupler to rear bumper of the trailer. SEE DISCLAIMER ON BACK PAGE.

# **BULLET**

*Ultra Lite*  
by Keystone



269RLS SHOWN IN GUNMETAL DECOR



**EASY TO TOW WITH THE NEW MORE FUEL EFFICIENT CROSSOVERS, CARS AND TRUCKS; THE BULLET ULTRA LITE TRAVEL TRAILER HERALDS IN A NEW GENERATION OF RVS.**

*Sleek and smooth on the outside and loaded with features and conveniences inside, the Bullet Ultra Lite will set you free to explore the open road.*



248RKS BEDROOM





**330BHS SHOWN IN SADDLEBROOK DECOR**



**248RKS MAIN SLIDE SHOWN IN GUNMETAL DECOR**



**330BHS BUNKROOM**



# BULLET ULTRA LITE EXTERIOR FEATURES



3 Year Warranty on BGS Exterior Graphics in AZ, CA, FL, NV, NM, TX, UT



Outside Kitchen (243BHS, 277BHS, 287QBS, 308BHS, and 311BHS)



Enclosed Underbelly with Ducted Heat



Magnetic Baggage Door Catches



Power Awning with LED Lights



43" Wide Stance Dexter Axles



Black Tank Flush



Triple 9" Easy Entrance Steps



Aluminum Framing Throughout (including slide boxes, pass-thru storage)



# BULLET ULTRA LITE INTERIOR FEATURES



32" LED TV in Main Living Area



Storage Doors Underneath Dinette Seating



Laundry Chute in Master Bedroom



Super Slides with Four Windows



Solid Wood Entry Doors to Bedroom and Bunkrooms



Flush Mount Range with Glass Top

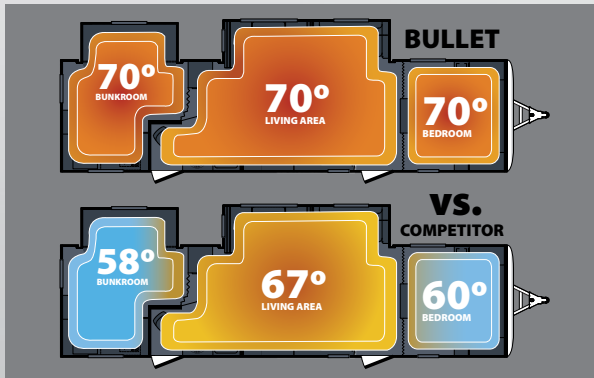

30,000 BTU Ducted Furnace



9" Deep Single Basin Kitchen Sink (N/A 220RBI, 311BHS, and 330BHS)



**BULLET**  
Ultra Lite  
by Keystone

# BULLET ULTRA LITE CONSTRUCTION



1. Quick Access LP Cover
2. Integrated Dual Battery Tray
3. Diamond Plate Stone Guard
4. Aerodynamic Front Profile
5. Hurricane Straps
6. 5" Radius Galvanized Stamped Steel Roof Trusses
7. Fully Insulated Roof
8. Durable Roof Decking
9. 13.5 Quick Cool Air Conditioner
10. One Piece TPO Roof
11. Full Length Rain Gutter and 4" Drip Spouts
12. Smooth Fiberglass Exterior
13. 1/8" Luan Wall Backing
14. Hi-Density Block Foam Insulation
15. 1 1/2" Box Welded Aluminum Frame Structure
16. Decorative Interior Wall Board
17. Aluminum Frame Slide Boxes
18. Bullet's Multi Seal and Track Slide System
19. Radial Tires with Electric Brakes (4)
20. Wide Stance Axle System
21. Easy Lube Dexter Axles
22. Beauflor Linoleum (resistant to cold cracking)
23. Plyveneer Floor Decking (water resistant)
24. Hi-Density Block Foam Insulation in Floor
25. Double Welded Aluminum Floor Joists
26. 3rd Layer Floor Decking
27. Radius Triple Entry Steps
28. 7.5" - 10.5" Steel Z-Beam Norco Frame
29. Darco Moisture Barrier Wrap
30. Heated and Enclosed Underbelly
31. Aluminum Framed Pass-Thru Storage



## SAVE MONEY ON FUEL

Our lightweight floor plans are 1000-1500 lbs. lighter than comparable competitor's trailers.



## RADIUS FRONT PROFILE VS. COMPETITION

The radius front profile of the Bullet travel trailer gives the optimal contour to reduce wind resistance when traveling down the road.



# BULLET ULTRA LITE FLOOR PLANS



**220RBI**



**243BHS**

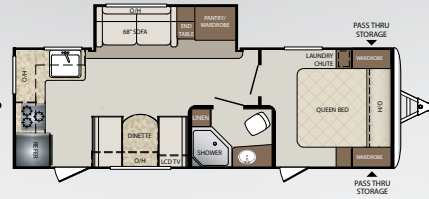

**248RKS**



**251RBS**

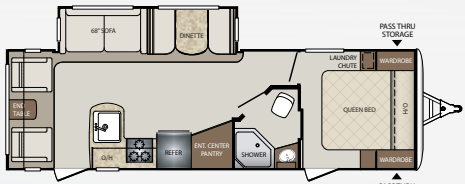

**269RLS UPDATED**

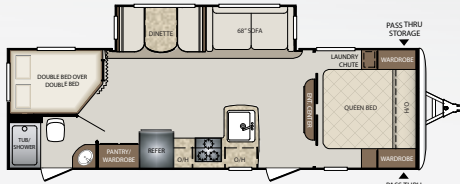

**272BHS**

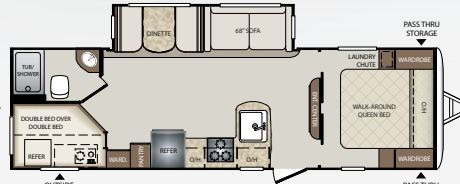

**277BHS NEW**



**287QBS**



**308BHS**

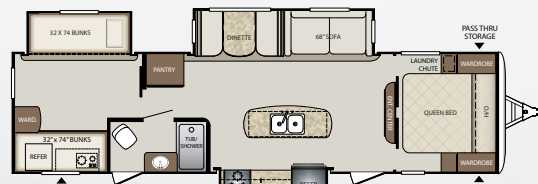

**311BHS**

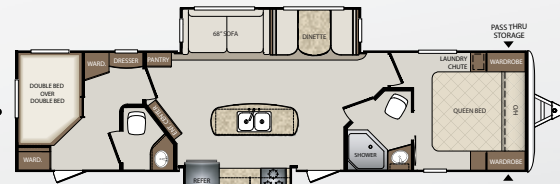

**330BHS NEW**

## BULLET WEIGHTS AND MEASUREMENTS

MODEL	SHIPPING WEIGHT	CARRYING CAPACITY	HITCH	LENGTH*	HEIGHT	FRESH WATER	WASTE WATER	GRAY WATER	LPG	AWNING
220RBI	4611	1789	450	25' 7"	10' 8"	43	30	30	40	15'
243BHS	4703	1797	555	27' 10"	10' 8"	43	30	30	40	19'
248RKS	4859	1641	535	28' 10"	10' 8"	43	30	60	40	15'
251RBS	4963	2037	500	29' 1"	10' 8"	43	30	30	40	14'
269RLS	5193	2392	585	31' 5"	10' 8"	43	30	30	40	15'
272BHS	5068	2472	540	30' 9"	10' 8"	43	30	30	40	15'
277BHS	5350	2235	585	31' 7"	10' 8"	43	30	30	40	20'
287QBS	5477	2123	695	32' 10"	10' 8"	43	30	30	40	15'
308BHS	6248	1352	700	35' 6"	10' 8"	43	30	30	40	19'
311BHS	6855	1945	865	35' 8"	10' 11"	43	30	60	40	19'
330BHS	6850	1750	810	37' 6"	10' 11"	43	60	30	40	20'

\*Length is defined as the distance from the centerline of the hitch pin/coupler to rear bumper of the trailer. SEE DISCLAIMER ON BACK PAGE.

# PREMIER

— ULTRA LITE BY BULLET —

PREMIER TRAVEL TRAILERS



34BHPR SHOWN IN SADDLEBROOK DECOR



**THE INDUSTRY'S FIRST LUXURY  
LIGHTWEIGHT TRAVEL TRAILER.**

Premier offers luxury, progressive styling, and high impact features all at a weight & price never seen before.



30R1PR KITCHEN WITH OPTIONAL FREE-STANDING DINETTE AND CHAIRS





**34BHPR BUNKROOM**



**24RKPR SHOWN IN SADDLEBROOK DECOR**



**OPTIONAL FREE-STANDING DINETTE**



**26RBPR SHOWN IN GUNMETAL DECOR**



# PREMIER EXTERIOR FEATURES



**Full Fiberglass Automotive Painted Cap with LED Docking Lights**



**Tinted Frameless Privacy Windows**



**Enclosed Underbelly with Ducted Heat**



**Magnetic Baggage Door Catches**



**Power Awning with LED Lights**



**43" Wide Stance Dexter Axles**



**Slam Latch Baggage Doors**



**Triple 9" Easy Entrance Steps**



**TPO Roll Over Roof**



# ***PREMIER INTERIOR FEATURES***



**Vaulted Ceiling**



**Stor-Mor Drawers Under Booth Dinette**



**Laundry Chute in Master Bedroom**



**LG Solid Surface Countertops in Kitchen**



**8 cu. ft. Refrigerator**



**Residential Backsplash in Kitchen**



**LED Puck Lights**



**60" x 80" Residential Queen Size Beds**



**Stainless Steel Dual Basin Sink w/ Pull-Down Sprayer Faucet**

# PREMIER CONSTRUCTION

Keystone's multi-coat paint facility applies three layers of base coat followed by two layers of automotive clear coat. This results in a deeper color & shinier finish than the competitions dyed fiberglass or ABS caps.



1. Power Tongue Jack
2. Quick Access LP Cover
3. Integrated Dual Battery Tray
4. LED Docking Lights
5. Radius Fiberglass Front Cap
6. 5" Radius Galvanized Stamped Steel Roof Trusses
7. Hurricane Straps
8. Fully Insulated Roof
9. Durable Roof Decking
10. One Piece TPO Roof
11. 13,500 BTU Quick Cool Air Conditioning (optional 2nd 13,500 BTU A/C)
12. Full Length Rain Gutter and 4" Drip Spouts
13. Rolled Roof Edge
14. Smooth Fiberglass Exterior
15. 1/8" Luan Wall Backing
16. Hi-Density Block Foam Insulation
17. 1 1/2" Box Double Welded Aluminum Frame Structure
18. Decorative Interior Wall Board
19. Residential Stain Resistant Beauflor Linoleum (resistant to cold cracking)
20. Plyveneer Floor Decking (water resistant)
21. Hi-Density Block Foam Insulation in Floor
22. Double Welded Aluminum Floor Joists
23. 3rd Layer Floor Decking
24. 7.5" - 10.5" Steel Z-Beam Frame
25. Darco Vapor Barrier Wrap
26. Heated and Enclosed Underbelly
27. Radial Tires with Electric Brakes (4)
28. 43" Wide Stance Axles
29. Easy Lube Axles
30. Triple Entry Radius Entry Steps
31. Frameless Jalousie Tinted Windows



## BENEFITS OF A MOLDED PAINTED FIBERGLASS FRONT CAP

- ✓ 1/4" thick molded painted fiberglass won't cold crack and is strong enough to hold up to rock damage unlike competitors ABS panels.
- ✓ A true "cap" is molded over the edges of the sidewall/roof/floor and "caps" the front end of the trailer preventing any water leaks. Many competitors "caps" are flat ABS panels that have 90 degree seams where it meets the sidewall. They also have a seam between the panel and rock guard which invites water intrusion.

## COMPETITION





# PREMIER FLOOR PLANS

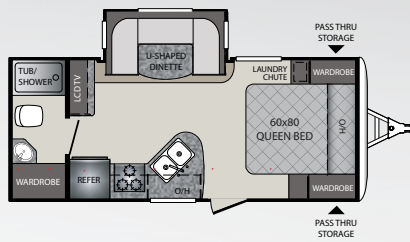

**19FBPR**

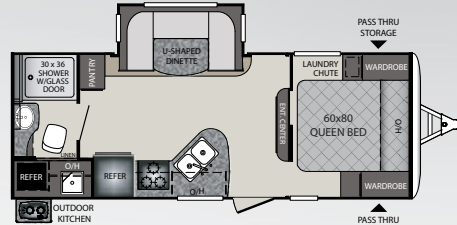

**22RBPR**

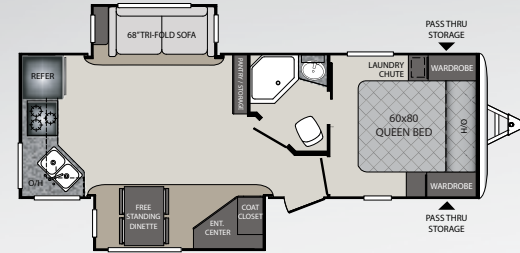

**24RKPR NEW**

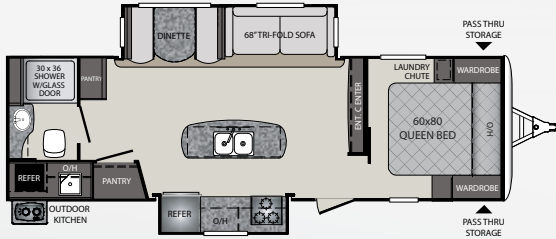

**26RBPR**

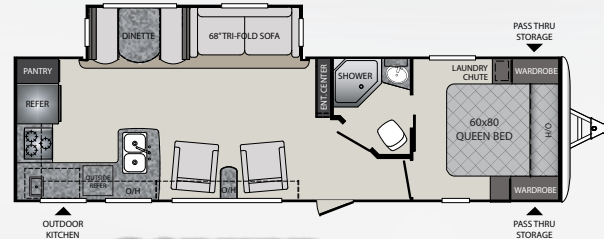

**29RKPR UPDATED**

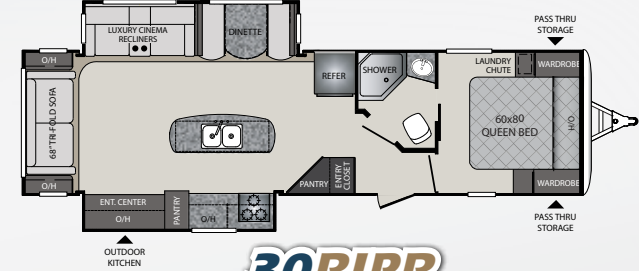

**30RIPR**



**31BKPR NEW**

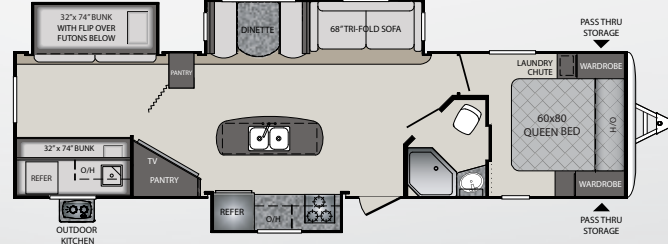

**34BHPR**

## PREMIER WEIGHTS AND MEASUREMENTS

MODEL	SHIPPING WEIGHT	CARRYING CAPACITY	HITCH	LENGTH*	HEIGHT	FRESH WATER	WASTE WATER	GRAY WATER	LPG	AWNING
<b>19FBPR</b>	4246	2230	485	23' 9"	11'	43	30	30	40	14'
<b>22RBPR</b>	4885	1615	595	26' 5"	11'	43	30	30	40	15'
<b>24RKPR</b>	5455	2085	655	29'	11'	43	30	60	40	15'
<b>26RBPR</b>	5995	1535	765	31' 6"	11'	43	30	60	40	20'
<b>29RKPR</b>	6145	1545	690	33' 11"	11' 1"	43	30	60	40	15'
<b>30RIPR</b>	6667	1525	740	35' 5"	11' 2"	43	30	60	40	20'
<b>31BKPR</b>	6750	2165	850	35' 11"	11' 4"	43	30	30	40	19'
<b>34BHPR</b>	7075	1670	790	37' 7"	11' 4"	43	30	60	40	19'

\*Length is defined as the distance from the centerline of the hitch pin/coupler to rear bumper of the trailer. SEE DISCLAIMER ON BACK PAGE.

## DECOR OPTIONS

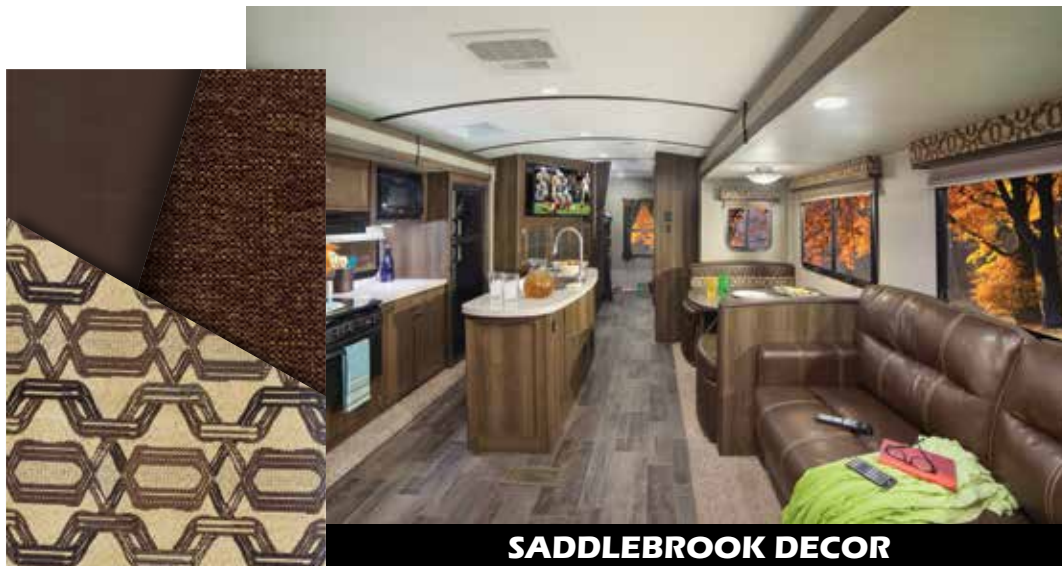

Bullet Crossfire, Bullet Ultra-Lite and Premier is always just a touch away. You'll find 360 virtual tours, location of your nearest dealer, photos, videos and all of the latest information on our easy to navigate website.

Everything you need can be accessed anytime, day or night, from home or on the road.

You can also find us on the Keystone RV Facebook page.

[www.keystonerv.com/Bullet](http://www.keystonerv.com/Bullet)  
**BULLET**  
 CROSSFIRE

[www.keystonerv.com/Bullet](http://www.keystonerv.com/Bullet)  
**BULLET**  
 Ultra Lite

[www.keystonerv.com/Premier](http://www.keystonerv.com/Premier)  
**PREMIER**  
 — ULTRA LITE BY BULLET —



# STANDARDS AND OPTIONS

	CROSSFIRE	BULLET	PREMIER
<b>CONSTRUCTION STANDARDS</b>			
Aggressive Front Profile for Increased Towability	●	●	●
Aluminum Framed Front, Rear, and Side Walls	●	●	●
Aluminum Framed Slideouts	●	●	●
Laminated Fiberglass Exterior Side Walls	●	●	●
2" Thick Laminated Aluminum Floor	●	●	●
Darco Moisture Barrier	●	●	●
One Piece TPO Roof	●	●	●
E-Z Lube Dexter Axles	●	●	●
Electric Brake System (4 wheels)	●	●	●
R-11 Insulation in Floor	●	●	●
R-7 Insulation in Sidewalls	●	●	●
R-11 Insulation in Roof	●	●	●
In Frame Fresh, Grey, and Black Water Tanks		●	●
7.5" - 10.5" Steel Z-Beam with Full-Length Welded Outrigger		●	●
¼" ABS Enclosed Underbelly		●	●
<b>EXTERIOR CAMPING PACKAGE</b>			
6 Gallon Gas/Electric DSI Water Heater with Quick Recovery	●	●	●
Radius Entry Door with Gas Strut	●	●	●
Outside Speakers	●	●	●
4 Stabilizer Jacks	●	●	●
TV Antenna and Cable/Satellite Hook-Up	●	●	●
Radial Tires	●	●	●
Electric Awning	●	●	●
LED Awning Light		●	●
Wide Stance E-Z Lube Dexter Axles		●	●
Outside Shower (Hot and Cold Water)		●	●
Black Tank Flush		●	●
<b>EXTERIOR FEATURES</b>			
Dual Propane Tanks with Cover	●	●	●
In Frame Dual Battery Rack	●	●	●
Spare Tire	●	●	●
Extended 4" Down Spouts	●	●	●
Front Diamond Plate	●	●	
Oversized Grab Handle (main door)		●	●
9" Triple Entry Steps		●	●
Magnetic Storage Door Catches		●	●
Aluminum Wheels		●	●
Oversized Exterior Pass Thru Storage with Lighting		●	●
LP Quick Connect		●	●
Outdoor Kitchen with Galvanized Countertop (22RBPR, 29RKPR, 30RIPR, 31BHPR, 34BHPR)			●

	CROSSFIRE	BULLET	PREMIER
<b>INTERIOR CAMPING PACKAGE</b>			
13.5 BTU A/C	●	●	●
Night Shades	●	●	●
Bluetooth Stereo with Aux and I-Pod Hookup	●	●	●
Microwave	●	●	●
Hardwood Cabinet Doors	●	●	●
Foot Flush Toilet	●	●	●
Tub Surround with Shelves	●	●	●
Full Extension Drawer Glides	●	●	●
9" Deep Oversized Single Basin Sink with High Rise Faucet (N/A 220, 311)	●	●	
6 cu./ft. Double Door Refrigerator	●	●	
Stainless Steel Sink (Bullet 220, 311, 330 Only)		●	●
32" LED TV (19FBPR, 22RBPR, 29RKPR, 30REPR, 31BHPR)		●	●
Flush Mount 3 Burner Range with Glass Cover		●	●
42" LED TV (26RBPR, 30RIPR, 34BH)			●
8 cu./ft. Double Door Refrigerator			●
2 Burner Cooktop	●		
<b>INTERIOR FEATURES</b>			
Residential Style Furniture	●	●	●
Night Shades in Living Area	●	●	●
Water Heater-By-Pass for Winterization	●	●	●
Interior LED Lights	●	●	●
17" Oven		●	●
Back Splash (residential)			●
Stor-mor Dinette			●
Retractable Kitchen Faucet			●
<b>BATHROOM</b>			
Towel Hooks	●	●	●
Power Vent Fan	●	●	●
Solid Wood Medicine Cabinet	●	●	●
Linen Storage	●	●	●
Deluxe Curved Shower Curtain	●	●	
Oversized Showers w/GlassDoor (N/A on 19FBPR, 31BHPR)			●

	CROSSFIRE	BULLET	PREMIER
<b>MASTER BEDROOM</b>			
Upgraded Foam Mattress	●	●	●
Dual 110V Outlets	●	●	●
Mirrored Wardrobes	●	●	●
Under Bed Storage	●	●	●
Full Blackout Window Curtains	●	●	●
Individual LED Reading Lights		●	●
Hardwood Entry Doors		●	●
Laundry Chute		●	●
<b>SAFETY EQUIPMENT</b>			
Carbon Monoxide Detector	●	●	●
Smoke Alarm	●	●	●
Fire Extinguisher	●	●	●
Electric Brakes	●	●	●
Safety Chains	●	●	●
Frameless Tinted Safety Glass Windows, Egress Windows (Fire Escape)	●	●	●
GFI Receptacless	●	●	●
<b>OPTIONS</b>			
Bumper Mounted Aussie Grill		●	●
15K A/C		●	●
50 AMP Service w/second A/C (N/A Premier 19FBPR, 22RBPR) (Bullet 308, 311, 330 Only)		●	●
Tri-Fold Sofa (N/A 220, 243)		●	
<b>THERMAL PACKAGE</b>			
Ducted Heat and Enclosed Heated Underbelly		●	●
2" Duct off of Furnace to Underbelly		●	●
30K BTU Furnace and Residential Heat Ducts		●	●
<b>PREMIER PACKAGE</b>			
Aerodynamic Fiberglass Front Cap			●
6' 11" Vaulted Ceiling			●
Frameless Tinted Windows			●
Power Tongue Jack			●
Tri-Fold Sofa			●
Max Depth Slides			●
LED Flush Mounted Puck Lighting			●
Upgraded Exterior Graphics Package			●
Black Tank Flush			●



**BULLET**  
CROSSFIRE

**BULLET**  
Ultra Lite

**PREMIER**  
— ULTRA LITE BY BULLET —

**WWW.KEYSTONERV.COM/BULLET**



CONNECT WITH KEYSTONE RV AND STAY UP TO DATE WITH PRODUCT NEWS AND INFORMATION



2642 Hackberry Drive  
PO Box 2000  
Goshen, IN 46527-2000  
(574) 535-2100



[www.keystonerv.com](http://www.keystonerv.com)

YOUR LOCAL DEALER:

## BUY LOCAL PURCHASING YOUR RV LOCALLY

MAY 2017

It's up to you where you purchase your new Bullet, but may we suggest your local dealer? Not only does it help your local economy and provide jobs, but it will also give you an opportunity to develop a service relationship with someone that will come to know you and your coach. Congratulations on finding the best built, best equipped, best value in the industry, and happy travels!

Product information is as accurate as possible at the date of publication of this brochure. Features, floor plans, and specifications are subject to change without notice. Please also consult Keystone's web site at [keystonerv.com](http://keystonerv.com) for more current product information and specifications. Tow Vehicle Disclaimer. CAUTION: Owners of Keystone recreational vehicles are solely responsible for the selection and proper use of tow vehicles. All customers should consult with a motor vehicle manufacturer or their dealer concerning the purchase and use of suitable tow vehicles for Keystone products. Keystone disclaims any liability or damages suffered as a result of the selection, operation, use or misuse of a tow vehicle. KEYSTONE'S LIMITED WARRANTY DOES NOT COVER DAMAGE TO THE RECREATIONAL VEHICLE OR THE TOW VEHICLE AS A RESULT OF THE SELECTION, OPERATION, USE OR MISUSE OF THE TOW VEHICLE. \*Length is defined as the distance from the centerline to the hitch pin/coupler to rear bumper of the trailer.