

**BULLET**  
ULTRA LITE

LIGHTWEIGHT VEHICLES • Crossover Vehicles • 1/2 TON TRUCKS

# BULLET

**ULTRA LITE**  
by Keystone



A NEW ERA IN ULTRA LITES  
[www.keystonerv-bullet.com](http://www.keystonerv-bullet.com)





**BULLET**  
ULTRA LITE  
by Keystone

284RLS | SHOWN IN GARDEN VIEW DECOR

1

## WHAT IS BULLET?

The Bullet is a full-featured ultra lite travel trailer designed to be towed by the new fuel-efficient SUVs, crossover vehicles and 1/2-ton pick-up trucks.

[www.keystonerv-bullet.com](http://www.keystonerv-bullet.com)

## CONVENIENCE, COMFORT AND STYLE

While other ultra lite trailers cut corners to save weight, with Bullet you enjoy ultra lite towing without sacrificing features and eye appeal. For example, Bullet's sleek aerodynamic front profile, wide-stance axle system, and contoured fender skirts create a trailer that tows with ease and looks great. Front diamond-plate rockguard, LED docking lights, radius crowned roof, lighted pass-thru storage, gas-strut entrance door assist, raised solid wood cabinet doors and electric awning are more features you'll find in the Bullet that you won't see on other ultra lites.

Bullet's attention to detail doesn't stop with the exterior. Inside Bullet you'll appreciate the plush, high back sofa, upgraded fabrics, window night shades, solid hardwood raised-panel cabinet doors, 9" single basin kitchen sink, and comfortable queen-sized bed with innerspring mattress. You will truly feel at home. Bullet's careful attention to detail and thoughtful use of space result in the most livable ultra lite on the market today.





286QBS | BUNK ROOM

2



286QBS | SHOWN IN GODIVA DECOR

3



1

The **plush interior** of the 284RLS is sure to help you relax. Take a seat in the large pillow backed swivel chairs and gaze outside the huge rear window. Bullet is the only travel trailer in its class to offer an air bed sofa sleeper, which is much more comfortable than a thin foam pad!

2

The **bunkroom** of the 286QBS provides plenty of sleeping options for either kids or adults. Functional closet provides a convenient area for clothes and toys.

3

**Redesigned galley slideout** provides more floor space with functional kitchen countertop space and an abundance of storage.

4

Enjoy the amenities of an **outdoor kitchen** without having to pull all of the weight of a traditionally built travel trailer. The 286QBS weighs in at approximately 5250 lbs.!



286QBS | OUTDOOR KITCHEN

4

## #1 MANUFACTURER

Own with confidence. Bullet is a division of Keystone RV Company, the number one manufacturer of towable RVs in North America. You can count on Keystone for quality and support in the years ahead.



# BULLET

www.keystonerv-bullet.com

ULTRA LITE  
by Keystone

## EXTERIOR FEATURES



Largest **pass-thru storage** in its class. 40.3 cubic ft. of storage provides an abundance of space for all of your camping gear.



**Jalousie windows** allow you to keep the windows open for air flow, even when it's raining.



**Electric awning** with adjustable arms makes it easy to extend/retract the awning as well as adjust the ends for water run-off.



**Gas struts** eliminate the concerns of replacing brittle plastic door catches.



**Wide stance axles** provide a better towing experience by reducing bounce and sway during travel.



**Exterior shower** comes equipped with a fixed shower head and access to both hot and cold water.

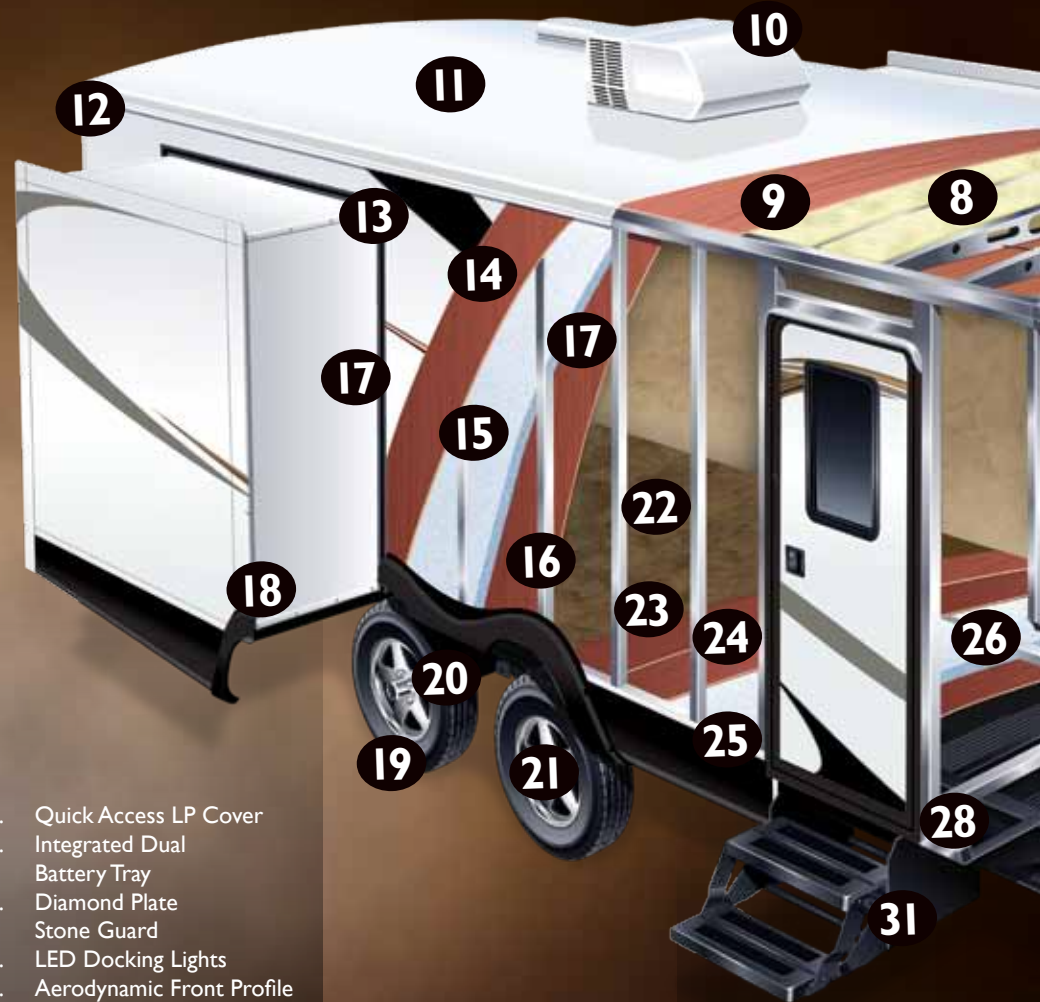

1. Quick Access LP Cover
2. Integrated Dual Battery Tray
3. Diamond Plate Stone Guard
4. LED Docking Lights
5. Aerodynamic Front Profile
6. Hurricane Straps
7. 5" Radius Galvanized Roof Trusses
8. Fully Insulated Roof
9. Durable Roof Decking
10. 13.5 Quick Cool Air Conditioning
11. One Piece EPDM Rubber Roof
12. Full Length Rain Gutter
13. Smooth Fiberglass Exterior
14. 1/8" Luan Wall Backing

15. Hi-Density Block Foam Insulation
16. 1 1/2" Box Welded Aluminum Frame Structure
17. Decorative Interior Wall Board
18. Bullet's Multi Seal and Track Slide System
19. Radial Tires with Electric Breaks (4)
20. Wide Stance Axle System
21. Easy Lube Axles

22. Residential Stain Resistant Linoleum
23. 1st Layer Floor Decking
24. 2nd Layer Floor Decking
25. Hi-Density In Floor Block Foam Insulation
26. Welded Aluminum Floor Joists

# LIGHTWEIGHT SOLID CONSTRUCTION



- 27. 3rd Layer Floor Decking
- 28. Paco/I - Beam Frame
- 29. Darco Moisture Barrier Wrap
- 30. Enclosed Underbelly
- 31. Radius Entry Steps



LOOK FOR BULLET VIDEOS AT  
[www.keystonerv-bullet.com](http://www.keystonerv-bullet.com)

## INTERIOR FEATURES



**Laundry chute** provides a convenient place to dispose of dirty clothes until you get home.



**9" Single Basin Kitchen Sink** allows enough size and depth for washing pots & pans.



**Monitor Panel** provides a central location for patio awning, slideout and light switches



**Large dinette** provides enough room for four adults to sit and enjoy a meal.



**Blackout shades** provide a durable, kid-friendly alternative for blocking out sunlight.



**CD/DVD/AM/FM Stereo w/ MP3 hookup** gives you multiple options for entertainment on those rainy days at the campground.



**Air Bed Sofa** offers a relaxed place to lounge during the day and gives your guests a comfortable sleeping option at night.



**Swivel TV** (per floorplan) eliminates the need to bring a second television for the master bedroom.





**217RBS**



**246RBS**



**281BHS**



**286QBS**

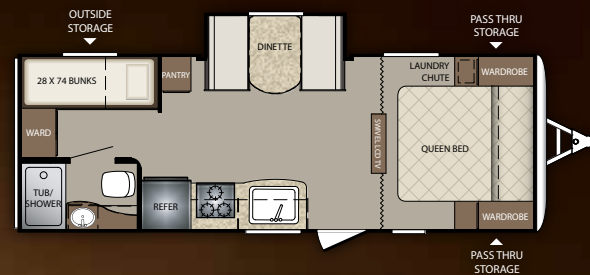

**230BHS**

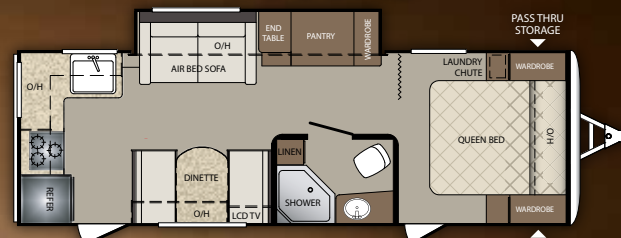

**248RKS**

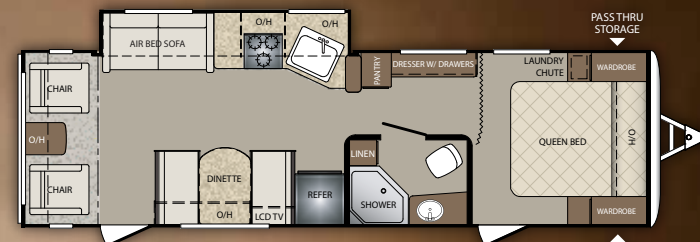

**284RLS**



**294BHS**

| TRAVEL TRAILERS       | 217RBS | 230BHS | 246RBS | 248RKS  | 281RBS | 284RLS | 286QBS  | 294BHS |
|-----------------------|--------|--------|--------|---------|--------|--------|---------|--------|
| SHIPPING WEIGHT       | 4290   | 4378   | 4910   | 4785    | 5125   | 5400   | 5230    | 5635   |
| CARRYING CAPACITY     | 2110   | 2097   | 1635   | 1715    | 2465   | 2200   | 2355    | 1890   |
| HITCH WEIGHT          | 490    | 475    | 545    | 545     | 590    | 625    | 585     | 725    |
| EXTERIOR LENGTH       | 25' 4" | 27' 0" | 28' 3" | 28' 10" | 31' 8" | 32' 1" | 32' 10" | 33' 8" |
| EXTERIOR WIDTH        | 8'     | 8'     | 8'     | 8'      | 8'     | 8'     | 8'      | 8'     |
| EXT. HEIGHT - A/C TOP | 10' 3" | 10' 3" | 10' 3" | 10' 3"  | 10' 3" | 10' 3" | 10' 3"  | 10' 5" |
| FRESH WATER (GAL.)    | 41     | 41     | 41     | 41      | 41     | 41     | 41      | 41     |
| WASTE WATER (GAL.)    | 30     | 30     | 30     | 30      | 30     | 30     | 30      | 30     |
| GRAY WATER (GAL.)     | 30     | 30     | 30     | 60      | 30     | 30     | 30      | 30     |
| LP CAPACITY (LBS.)    | 40     | 40     | 40     | 40      | 40     | 40     | 40      | 40     |

**LEARN MORE**

Get the free app at <http://gettag.mobi> and scan this tag.

## SCAN FOR SNAPSHOTS

Scan the QR code and look for the camera symbol to view interior snapshot photos on our website.



## FIFTH WHEELS

[www.keystonerv-bullet.com](http://www.keystonerv-bullet.com)



252FL | SHOWN IN GARDEN VIEW DECOR



## THE LIGHTWEIGHT FIFTH WHEEL HAS ARRIVED

Customers have been asking for a true ultra-light fifth wheel and Bullet has answered their request. Our fifth wheel lineup offers floorplans weighing well under 7,000lbs, allowing for them to be towed by most half ton trucks. Just like our travel trailer lineup – storage, comfort and eye appeal are not sacrificed with the weight savings.

| FIFTH WHEELS          | 252FL  | 260FB  |
|-----------------------|--------|--------|
| SHIPPING WEIGHT       | 6270   | 6435   |
| CARRYING CAPACITY     | 2530   | 2365   |
| HITCH WEIGHT          | 1055   | 1290   |
| EXTERIOR LENGTH       | 30' 0" | 32' 5" |
| EXTERIOR WIDTH        | 8'     | 8'     |
| EXT. HEIGHT - A/C TOP | 11' 3" | 11' 3" |
| FRESH WATER (GAL.)    | 41     | 41     |
| WASTE WATER (GAL.)    | 30     | 30     |
| GRAY WATER (GAL.)     | 30     | 30     |
| LP CAPACITY (LBS.)    | 40     | 40     |

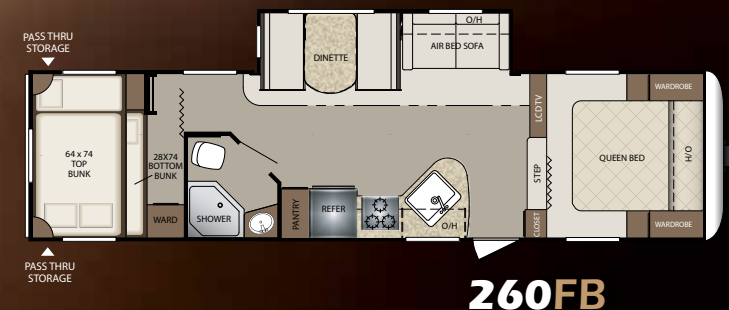



**GODIVA  
DECOR**

**SADDLE  
DECOR**

**GARDEN VIEW  
DECOR**
**CONSTRUCTION STANDARDS**

- Aggressive Front Profile for Increased Towability
- Aluminum Framed Front, End and Side Walls
- Laminated Fiberglass Exterior Side Walls
- 2" Thick Laminated Aluminum Floor
- In-Frame Fresh, Grey, and Black Water Tanks
- 6" and 8" I-Beam with Welded
- Outriggers
- 1/4" ABS Enclosed Underbelly
- Darco Moisture Barrier
- One Piece Seamless Rubber Roof
- E-Z Lube Axles
- Electric Brake System (4 wheels)
- R-11 Insulation in Floor
- R-7 Insulation in Sidewalls
- R-11 Insulation in Roof

**EXTERIOR CAMPING PACKAGE**

- Wide Stance E-Z Lube Axles
- 6 Gallon Gas/Electric DSI Water Heater
- Radius Entry Door with Gas Strut
- Outside Speakers
- Outside Shower (Hot & Cold Water)
- Tinted Safety Glass Windows
- 4 Stabilizer Jacks
- TV Antenna & Cable Hook-Up
- Electric Awning with Adjustable Arms
- Radial Tires

**EXTERIOR FEATURES**

- Dual Propane Tanks with Cover
- Front Diamond Plate
- In Frame Dual Battery Rack
- LED Docking Lights
- Oversized Exterior Pass Thru Storage with Lighting
- Contoured Fender Skirts for Increased Air-Flow
- LP Quick Connect
- Amber Patio Light
- Spare Tire
- Extended Down Spouts
- Double Entry Steps
- Black Tank Flush

**INTERIOR CAMPING PACKAGE**

- 13.5 BTU Ducted A/C
- Night Shades
- CD/DVD/AM/FM Stereo with Aux & I-Pod Hookup
- 19" LCD TV
- Microwave
- 6 cu./ft. Double Door Refrigerator
- 3 Burner High Output Range
- 9" Deep Oversized Single Basin Sink with High Rise Faucet
- Chestnut Glazed Hardwood Cabinet Doors
- Foot Flush Toilet
- Tub Surround with Shelves
- Full Extension Drawer Glides
- Air Bed Sofa (Select Models)

**INTERIOR FEATURES**

- 78" Interior Height
- Beauflor® Linoleum
- Swivel Rockers (Per Floor Plan)
- Pillow Back Furniture
- Swivel TV with Mirror (Per Floor Plan)
- Water Heater-By-Pass for Winterization
- Night Shades in Living Area
- 17" Oven
- Decorative Wall Border
- Bullet Monitor Panel

**BATHROOM**

- Towel Hooks
- Deluxe Curved Shower Curtain
- Power Vent Fan
- Solid Wood Medicine Cabinet
- Linen Storage

**MASTER BEDROOM**

- Upgraded Innerspring Mattress
- Dual 110V Outlets
- Mirrored Wardrobes
- Laundry Chute
- Under Bed Storage
- Full Blackout Window Treatments
- Individual Reading Lights

**BUNK ROOMS**

- Oversized Rollover Sofa with Rear Storage (294BHS)
- Cable & TV Hookups (Per Floorplan)
- Full Blackout Window Treatments
- Oversized Wardrobe with Rod (Some Floor Plans)

**THERMAL PACKAGE**

- Heated & Enclosed Underbelly
- 2" Pipe off of Furnace to Underbelly
- 30K BTU Furnace & Residential Heat Ducts

**SAFETY EQUIPMENT**

- Carbon Monoxide Detector
- Smoke Alarm
- Fire Extinguisher
- Electric Brakes
- Safety Chains
- Tinted Safety Glass Windows
- Egress Windows (Fire Escape)
- GFI Electrical Outlets

**OPTIONS**

- RVO Grill (N/A 286QBS)
- Aluminum Wheels (Mandatory)
- 15K A/C



[www.keystonerv-bullet.com](http://www.keystonerv-bullet.com)

**BULLET**  
ULTRA LITE  
by Keystone

 **Keystone RV  
Company**  
[www.keystonerv.com](http://www.keystonerv.com)

2642 Hackberry Drive | PO Box 2000  
Goshen, IN 46527-2000  
(574) 535-2100



Get the free app at  
<http://gettag.mobi>  
and scan this tag.

**YOUR LOCAL DEALER**

**RV WHOLESALE  
SUPERSTORE**  
Quality RV's at wholesale prices

SYLVANIA OH, 43560

1-844-601-1171 | [RVWSS.COM](http://RVWSS.COM)

Product information is as accurate as possible at the date of publication of this brochure. Features, floor plans, and specifications are subject to change without notice. Please also consult Keystone's web site at [keystonerv.com](http://keystonerv.com) for more current product information and specifications. Tow Vehicle Disclaimer. CAUTION: Owners of Keystone recreational vehicles are solely responsible for the selection and proper use of tow vehicles. All customers should consult with a motor vehicle manufacturer or their dealer concerning the purchase and use of suitable tow vehicles for Keystone products. Keystone disclaims any liability or damages suffered as a result of the selection, operation, use or misuse of a tow vehicle. KEYSTONE'S LIMITED WARRANTY DOES NOT COVER DAMAGE TO THE RECREATIONAL VEHICLE OR THE TOW VEHICLE AS A RESULT OF THE SELECTION, OPERATION, USE OR MISUSE OF THE TOW VEHICLE. 5/2012

Go RVing  
Life's A Trip

Member  
**RVIA**  
RECREATION VEHICLE  
INDUSTRY ASSOCIATION